

Priority order:	Project:	Location	Tons of Bituminous	Total Estimated Cost
1)	S.A.P. 053-618-023	C.S.A.H. 7 to T.H. 59	12,725	\$540,000
2)	S.A.P. 053-618-025	C.S.A.H. 9 to C.S.A.H. 7	7,200	\$420,000
3)	S.A.P. 053-607-016	C.S.A.H. 18 West to C.S.A.H. 18 East	3,500	\$192,000
4)	S.A.P. 053-609-019	C.S.A.H. 25 to C.S.A.H. 18	23,100	\$1,255,000
5)	S.A.P. 053-616-032	C.S.A.H. 25 to C.S.A.H. 9	9,000	\$518,000
6)	S.A.P. 053-613-019	Interstate 90 to C.S.A.H. 25	19,800	\$1,110,000
7)	S.A.P. 053-618-023	T.H. 91 to C.S.A.H. 13	17,350	\$915,000
8)	S.A.P. 053-605-012	C.S.A.H. 4 to C.S.A.H. 33	15,050	\$890,000
9)	S.A.P. 053-604-014	T.H. 60 to C.S.A.H. 5	12,450	\$726,000
10)	S.A.P. 053-603-028	T.H. 60 to C.S.A.H. 14	10,000	\$580,000
11)	S.A.P. 053-603-029	C.S.A.H. 14 to C.S.A.H. 16	12,900	\$765,000
12)	S.A.P. 053-616-033	T.H. 59 to C.S.A.H. 1	15,200	\$870,000
13)	S.A.P. 053-619-024	C.S.A.H. 35 West to C.S.A.H. 16	15,900	\$895,000

Prepared 9/23/2016 RAK/PTT

Total estimated amount: \$9,676,000

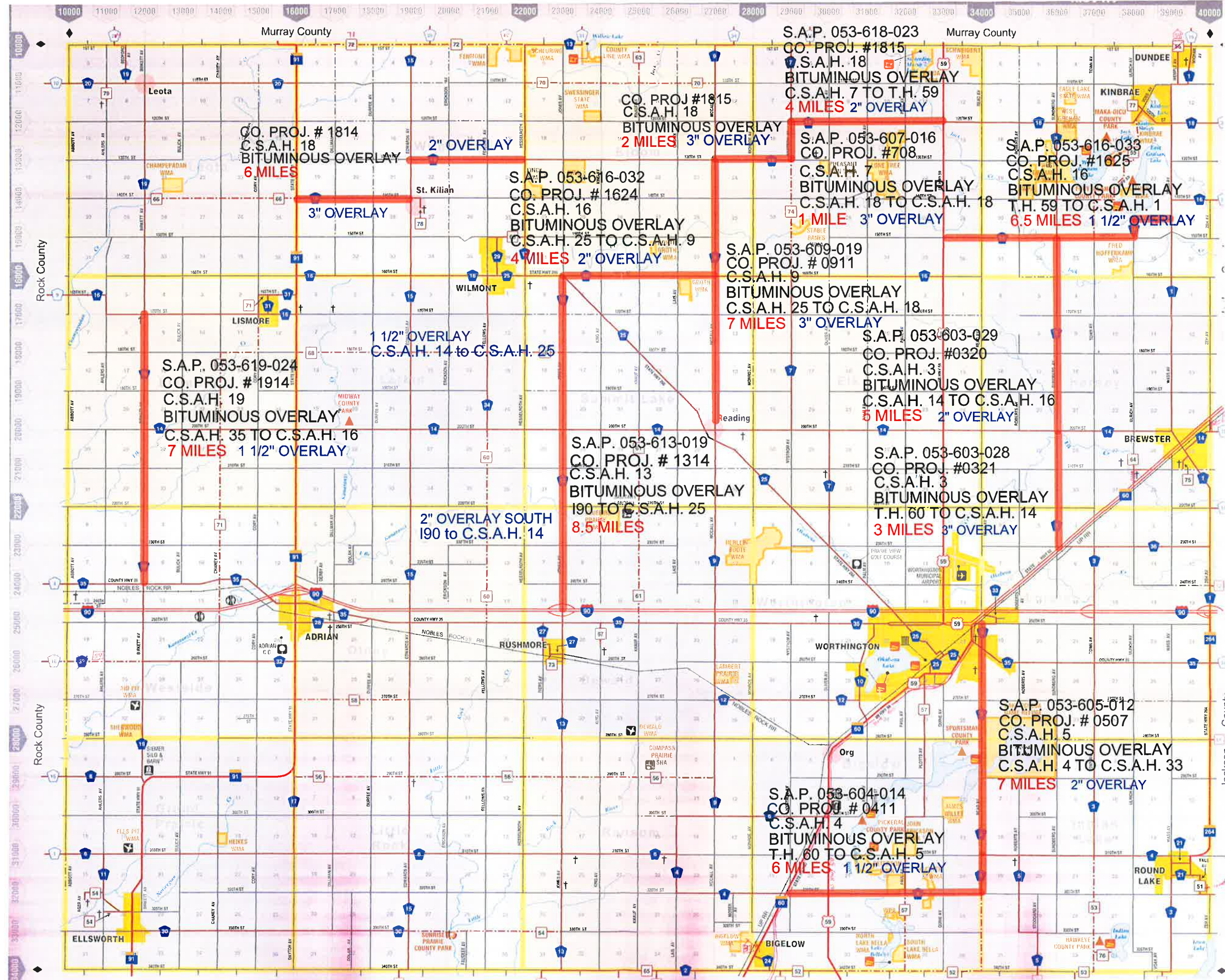

CO. PROJ. # 1814
C.S.A.H. 18
BITUMINOUS OVERLAY
6 MILES

2" OVERLAY

CO. PROJ. # 1815
C.S.A.H. 18
BITUMINOUS OVERLAY
2 MILES 3" OVERLAY

S.A.P. 053-618-023
CO. PROJ. # 1815
C.S.A.H. 18
BITUMINOUS OVERLAY
4 MILES 2" OVERLAY

S.A.P. 053-616-032
CO. PROJ. # 1624
C.S.A.H. 16
BITUMINOUS OVERLAY
C.S.A.H. 25 TO C.S.A.H. 9
4 MILES 2" OVERLAY

S.A.P. 053-607-016
CO. PROJ. # 708
C.S.A.H. 7
BITUMINOUS OVERLAY
C.S.A.H. 18 TO C.S.A.H. 18
1 MILE 3" OVERLAY

S.A.P. 053-616-033
CO. PROJ. # 1625
C.S.A.H. 16
BITUMINOUS OVERLAY
T.H. 59 TO C.S.A.H. 1
6.5 MILES 1 1/2" OVERLAY

3" OVERLAY

S.A.P. 053-609-019
CO. PROJ. # 0911
C.S.A.H. 9
BITUMINOUS OVERLAY
C.S.A.H. 25 TO C.S.A.H. 18
7 MILES 3" OVERLAY

1 1/2" OVERLAY
C.S.A.H. 14 to C.S.A.H. 25

S.A.P. 053-603-029
CO. PROJ. # 0320
C.S.A.H. 3
BITUMINOUS OVERLAY
C.S.A.H. 14 TO C.S.A.H. 16
5 MILES 2" OVERLAY

S.A.P. 053-619-024
CO. PROJ. # 1914
C.S.A.H. 19
BITUMINOUS OVERLAY
C.S.A.H. 35 TO C.S.A.H. 16
7 MILES 1 1/2" OVERLAY

S.A.P. 053-613-019
CO. PROJ. # 1314
C.S.A.H. 13
BITUMINOUS OVERLAY
I90 TO C.S.A.H. 25
8.5 MILES

2" OVERLAY SOUTH
I90 to C.S.A.H. 14

S.A.P. 053-603-028
CO. PROJ. # 0321
C.S.A.H. 3
BITUMINOUS OVERLAY
T.H. 60 TO C.S.A.H. 14
3 MILES 3" OVERLAY

S.A.P. 053-605-012
CO. PROJ. # 0507
C.S.A.H. 5
BITUMINOUS OVERLAY
C.S.A.H. 4 TO C.S.A.H. 33
7 MILES 2" OVERLAY

S.A.P. 053-604-014
CO. PROJ. # 0411
C.S.A.H. 4
BITUMINOUS OVERLAY
T.H. 60 TO C.S.A.H. 5
6 MILES 1 1/2" OVERLAY

