

**BOARD OF COMMISSIONERS**

315 Tenth Street  
P.O. Box 757  
Worthington, MN 56187-0757



Phone: 507-295-5201  
Fax: 507-372-8363  
commissioner@co.nobles.mn.us

*“In cooperation with our citizens, we improve the quality of life for individuals, families and communities by fostering a healthy economy and environment.”*

*“Looking forward with purpose”*

**COUNTY BOARD - PROPOSED ADDENDUM  
TUESDAY, MARCH 22, 2016**

**7.0 Administration Presentations**

**7.5 Proposed New Wind Farm Request for Comment** *(Information/Action)*

FIRST DISTRICT  
Marvin Zylstra

SECOND DISTRICT  
Gene Metz

THIRD DISTRICT  
Matt Widboom

FOURTH DISTRICT  
Robert Demuth Jr.

FIFTH DISTRICT  
Donald Linssen

## Cathy Roos

---

**From:** Tom Johnson  
**Sent:** Monday, March 21, 2016 8:06 AM  
**To:** Cathy Roos  
**Subject:** FW: Nobles 2 Wind Farm-Nobles County MN request for comment  
**Attachments:** Nobles2 Nobles County Admin agency letter\_160318.pdf

I am going to recommend we add this tomorrow, for comment.

Tom  
O: 507.295.5201

**"The past is experience, the present experiment, and the future expectations. Use your experience in your experiments to achieve your expectations." ~ Unknown**

---

**From:** Kelly Kunst [<mailto:Kelly.Kunst@westwoodps.com>]  
**Sent:** Friday, March 18, 2016 2:40 PM  
**To:** Tom Johnson  
**Cc:** Jay Regnier  
**Subject:** Nobles 2 Wind Farm-Nobles County MN request for comment

Mr. Johnson,  
On behalf of Nobles 2 Power Partners, LLC, attached is a letter and site location map requesting comment on the proposed Nobles 2 Wind Farm located in Nobles and portions of Murray County, MN.  
Regards,

**Kelly Kunst**  
**SENIOR ENVIRONMENTAL SCIENTIST**  
kelly.kunst@westwoodps.com

**Direct** (952) 906-7421  
**Main** (952) 937-5150  
**Cell** (952) 491-1077

**Westwood Multi-Disciplined Surveying & Engineering**  
7699 Anagram Drive | Eden Prairie, MN 55344

---

**westwoodps.com**  
(888) 937-5150

### Confidentiality Statement:

This message and any attachments may contain confidential, proprietary or legally privileged information. Any unauthorized dissemination, use, or disclosure of this information, either in whole or in part, is strictly prohibited. The contents of this e-mail are for the intended recipient and are not meant to be relied upon by anyone else. If you have received this message in error, please advise the sender by reply e-mail, and delete this message and any attachments. Thank you.



March 18, 2016

Tom Johnson-Administrator  
 Nobles County  
 315 Tenth Street  
 PO Box 757  
 Worthington, MN 56187

**Re: 250-300 MW Nobles 2 Wind Farm**  
 File 0001661.00

Dear Mr. Johnson:

Nobles 2 Power Partners, LLC (N2PP) requests your formal comments regarding the Applicant’s plans to obtain a Site Permit and Certificate of Need from the Minnesota Public Utilities Commission (PUC) for the 250 to 300 MW Nobles 2 Wind Farm Project (Project). N2PP plans to apply for a Site Permit and Certificate of Need from the PUC in spring 2016.

N2PP proposes to construct the Project in Nobles County in southwestern Minnesota (**Exhibit 1**). The overall “Project Area” is located in the Townships, Ranges, and Sections indicated in the table below.

Nobles 2 Wind Farm Project Area				
Township	Range	Sections	Township Name	County
104N	43W	13, 23-28, 33-36	Leota	Nobles
104N	42W	S1-4, 8-36	Wilmont	Nobles
104N	41W	S2-36	Bloom	Nobles
104N	40W	S18-19, 30-31	Seward	Nobles
103N	43W	S1-4	Lismore	Nobles
103N	42W	S1-6	Larkin	Nobles
103N	41W	S1-6, 11-14, 23-25	Summit Lake	Nobles
103N	40W	S4-9, 16-21, 28-30	Elk	Nobles
105N	42W	S34-36	Fenton	Murray

The Project is a Large Wind Energy Conversion System (LWECS), as defined in the Wind Siting Act, Minnesota Statutes § 216F.01, and a Site Permit is required for the Project under Minnesota Statutes § 216F.04. A Certificate of Need (CON) is also likely to be pursued for the Project.

Consistent with PUC objectives, N2PP is committed to designing the Project in an orderly manner compatible with environmental preservation, sustainable development, and the efficient use of resources. All decisions with respect to equipment selection, site layout, and spacing are designed to make the most

efficient use of land and wind resources while minimizing environmental impacts to the extent practicable. The turbine selected for the Project will be dependent on the most appropriate technology available at the time of ordering equipment prior to construction.

The Project will consist of approximately 150 wind turbines, gravel access roads, underground collection lines, step up transformers, permanent meteorological tower(s), and a step up substation. The location of proposed infrastructure has not been finalized. It is worth noting that several existing wind farms are located near the Project Area including Nobles (200 MW) and Community Wind South (30 MW) south of the Project Area, Fenton Wind Power Plant (205.5 MW) and Stoneray (not yet constructed) northwest of the Project Area, and Prairie Rose Wind (200 MW) approximately 10 miles west of the Project Area.

N2PP has engaged Westwood Professional Services to complete initial studies and permitting for the Project. At this point no permits have been issued and the Project has not yet been opened up for public comment.

We would appreciate any comments you may have regarding the proposed Project; comments received will be incorporated into the PUC review process. Please respond as soon as possible or within 30 days of the date of this letter.

If you have questions, please contact me at 612-284-4778 or at [jay.regnier@prcwind.com](mailto:jay.regnier@prcwind.com).

Sincerely,

NOBLES 2 POWER PARTNERS, LLC



Jay Regnier P.Eng.  
Director of Project Development

cc. Paul White, Nobles 2 Power Partners, LLC  
Kelly Kunst, Westwood Professional Services

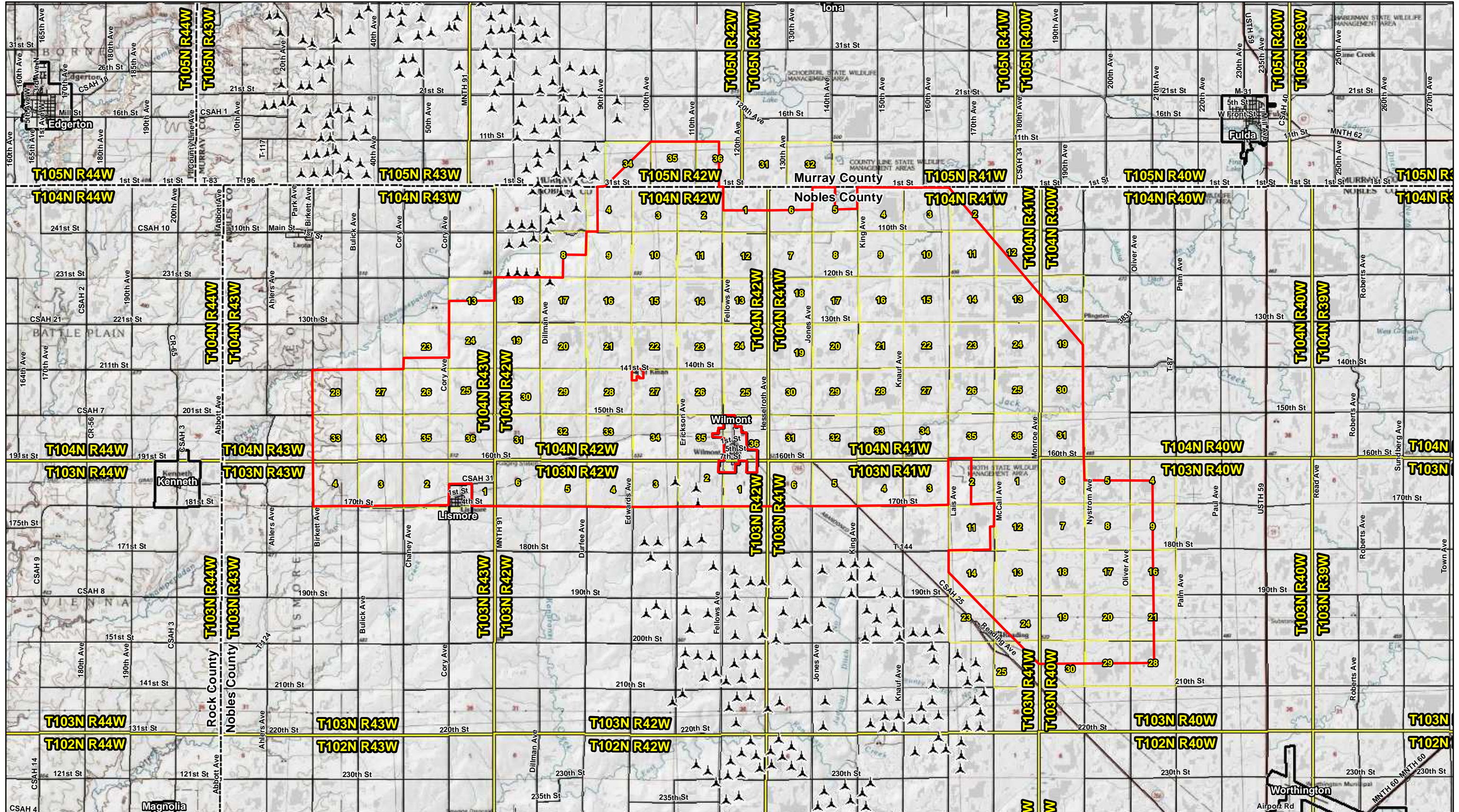

Data Source(s): Westwood (2016); Geospatial Data Gateway (various dates); ESRI Basemap, Imagery (accessed 2016); ESRI (2012); MnDOT (various dates).

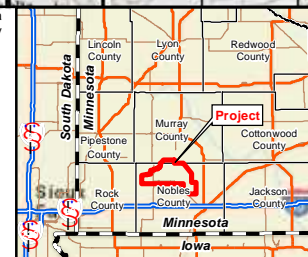

**Legend**

- Project Area
- County Boundary
- PLS Township Boundary
- Municipal Boundary
- PLS Section Boundary
- Road
- Existing Wind Turbine



# Nobles 2 Wind Project

Nobles and Murray County, Minnesota

Project Area &  
USGS Topography

EXHIBIT 1

**Westwood**

Toll Free (888) 937-5150 westwoodps.com  
Westwood Professional Services, Inc.

At the present time Nobles County is host to two large scale and numerous small scale wind projects. The projects owners and sponsors have always been professional to deal with and have not left the County or Townships with any issues to deal with during construction or since in operation. The production taxes have been an essential economic development for our County. Nobles County does not have any issues or concerns with the proposed Nobles 2 Wind Farm project.

---

**PUBLIC WORKS**

960 Diagonal Road  
PO Box 187  
Worthington, MN 56187-0187



---

Phone: 507-295-5322  
Fax: 507-372-8348  
PublicWorks@co.nobles.mn.us

March 21, 2016

Jay Regnier, P.E.  
Director of Project Development  
618 2<sup>nd</sup> Ave. SE  
Minneapolis, MN 55414

Dear Mr. Regnier,

Nobles County Environmental Services is excited to receive your request for comments for the Nobles 2 Wind Farm project. We have been working for the past year with development manager Ryan Ammermann to permit the necessary meteorological towers for the Environmental Reviews required by the State for this project.

Nobles County is experienced in working with the Public Utilities Commission on large wind energy conversion systems (LWECS). Nobles County Environmental Services believes the statewide standards for permitting such as setbacks for wind access, homes, noise standards, public roads, drain tile avoidance and repair, wetlands buffers, site determination, permittee responsibilities, surveys, decommissioning plans, reports, and additional standards adequately address the concerns of the our residents.

Nobles County's Planning and Zoning Commission looks forward to participating at the Minnesota Public Utilities Commission's meetings held for the draft permit. If we can be of assistance to you in the development of your project, please do not hesitate to contact us.

Sincerely,

Wayne Smith  
Environmental Services Director

## Tom Johnson

---

**From:** Stephen Schnieder  
**Sent:** Monday, March 21, 2016 2:28 PM  
**To:** Tom Johnson  
**Subject:** RE: Nobles 2 Wind Farm-Nobles County MN request for comment

Tom,

The following are items that were addressed in an agreement between the developer and the Highway Department the last time a wind tower project was done in Nobles County:

1. Permits for over dimensioned loads be acquired.
2. Permits for working in the road right of way be acquired
3. Permits for Driveway access and intersection improvements be acquired.
4. All roadways shall be maintained in a safe manor and be kept usable by the public during construction.
5. All signing shall be in accordance with the MN Manual on Uniform Traffic Control Devices.
6. All tile lines in the right of way shall be protected from damage, and if damaged restored to the standard set by Nobles County.
7. All County and Judicial Ditch System tile and drainage ditches on private property shall be restored to the standard set by Nobles County.  
Nobles County shall require all tile repairs to be inspected by Nobles County prior to the exaction being backfilled.
8. All damages to the roadway shall be restored. This includes the reestablishing the original road cross section, elevation and gravel surface.
9. Haul roads shall be established and vehicles, both loaded and empty, shall be required to use only the approved haul roads.
10. Paved roadways shall be bridged and detours established, in accordance with Nobles County Standards, for Cranes to cross over. Cranes are not permitted to travel down the road.
11. The developer shall enter into an agreement with Nobles County setting forth the conditions for the project.

Wayne Smith will be reviewing the project and will provide you with additional comments of his concerns.

I also contacted the Sheriff in case he has any concerns about the ARMOUR Radio communication towers interconnectivity. He had expressed line of sight concerns in the past.

Stephen P. Schnieder  
Public Works Director  
P O Box 187  
Worthington, MN 56187-0187  
Office 507-295-5322  
FAX 507-372-8348

---

**From:** Tom Johnson  
**Sent:** Monday, March 21, 2016 8:09 AM